

# oluce



## DUCA 1950

Nicola Gallizia  
2015

Lampada da parete a luce indiretta e riflessa. Struttura in metallo verniciato.

Wall lamp giving indirect and reflected light. Painted metal structure.

### DIMENSIONI/DIMENSIONS

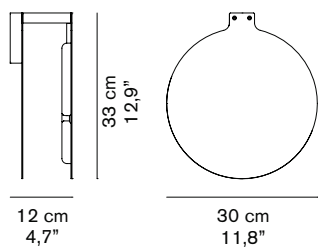

### MATERIALI/MATERIALS

metallo  
metal

### COLORE/COLORS

grigio caldo/warm grey

RAL7048

### SORGENTI/BULBS

LED 220V - 1 x max 14 W  
3000° K - 1350 lm - CRI > 85



fornita di led  
equipped with led

### MARCHI/MARKS



### INFORMAZIONI AGGIUNTIVE/ FURTHER INFORMATION



classe I  
class I



classe energetica: A<sup>+</sup>, A<sup>+</sup>, A  
energy class: A<sup>+</sup>, A<sup>+</sup>, A

### IMBALLO/PACKAGING



dim./dim. 38x36x16 cm / 14,9"x14,2"x6,3"  
volume/volume 0,0218 m<sup>3</sup> / 0,77 ft<sup>3</sup>  
peso/weight 4 kg / 8,81 lb

### TIPOLOGIA/TYPE

interno - lampada da parete  
indoor - wall lamp

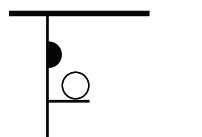

### CURVA FOTOMETRICA/ PHOTOMETRIC CURVE

