



# hype

DESIGN  
STUDIO KLASS

modello registrato  
registered model

portata sul piano: 150 kg  
load capacity on top: 150 kg

Tavolo con base in metallo verniciato, finitura "Grigio Lava". Piano in vetro temperato da 12 mm\* o da 15 mm fuso e retroverniciato con tinte metallizzate, (Cat.2) oppure in vetro trasparente o extralight retroverniciato con tinte monocromatiche (Cat.1) o con tinta speciale effetto materico (Cat.3).

Table with metal painted base, "Lava Grey" finish. Top available in 12\* or 15 mm high temperature melted and transparent glass, back-lacquered with metal shades (Cat.2), or with transparent or extralight glass back-lacquered with monochrome shade (Cat.1) or with textured effect shade (Cat.3).

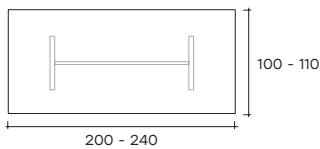
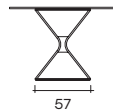
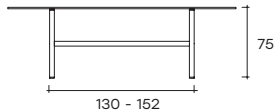

**Dimensioni su richiesta:** min. 200x100 cm - max. 260x120 cm.  
**Custom dimensions:** min. 200x100 cm - max. 260x120 cm.

dimensioni L, P, H dimensions L, W, H (cm)	COD./CODE	L	P/W	H	peso netto net weight (kg)	peso lordo gross weight (kg)	volume imballo package volume (m <sup>3</sup> )
Tavolo con piano in vetro trasparente retroverniciato in tinta Cat.1. <i>Table with top in transparent back-lacquered glass - color Cat.1.</i>	<b>*HP200/V-</b>	200	100	75	96	153	0,70
	<b>HP240/V-</b>	240	110	75	136	205	0,75
Tavolo con piano in vetro trasparente fuso retroverniciato in tinta Cat.2. <i>Table with top in transparent melted back-lacquered glass - color Cat.2.</i>	<b>*HP200/VF-</b>	200	100	75	96	153	0,70
	<b>HP240/VF-</b>	240	110	75	136	205	0,75
Tavolo con piano in vetro extralight acidato retroverniciato in tinta Cat.3. <i>Table with top in extralight acid-etched back-lacquered glass - color Cat.3.</i>	<b>*HP200/VXA-<sub>-</sub></b>	200	100	75	96	153	0,70
	<b>HP240/VXA-<sub>-</sub></b>	240	110	75	136	205	0,75

## VETRO RETROVERNICIATO \_ BACK PAINTED GLASS

CAT. COLORE COLOR CAT.	COLORI COLORS	CODICE _ CODE		
		Vetro trasparente Transparent glass	Vetro trasparente fuso Fused transparent glass	Vetro extralight acidato Etched extralight glass
<b>CAT.1</b> Tinta unita Plain color	Grigio grafite Grey graphite	<b>V-GR</b>		
	Rosso vinaccia Wine red	<b>V-VI</b>		
	Testa di moro Dark brown	<b>V-MR</b>		
<b>CAT.2</b> Tinta metallizzata Metallic color	Grigio lava Lava grey		<b>VF-LA</b>	
	Marrone ramato Copper brown		<b>VF-RA</b>	
<b>CAT.3</b> Tinta speciale effetto materico Textured effect	Marrone nuvolato Cloudy brown			<b>VXA-MN</b>
	Piombo satinato Glazed lead			<b>VXA-PS</b>

Hype è disponibile anche nelle altre finiture di Cat.2 per vetro fuso.  
Hype èis also available in the other finishes of fused glass Cat.2.



# hype

DESIGN  
STUDIO KLASS

modello registrato  
registered model

portata sul piano: 150 kg  
portata sulla prolunga: 30 kg  
load capacity on top: 150 kg  
extension load capacity: 30 kg

Tavolo allungabile con base in metallo verniciato, finitura Grigio Lava. Piano ed allunghe in vetro temperato da 12 mm fuso e retro verniciato con tinte metallizzate, oppure in vetro trasparente o extralight retroverniciato con tinte monocromatiche o con tinta speciale effetto materico.

Extendible table with base in painted metal, Lava Grey finish. Top and extensions are available in 12 mm tempered fused glass, back-lacquered with metal shades, or in transparent or extralight back-lacquered glass with monochrome shade or with a textured effect.

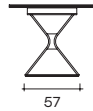
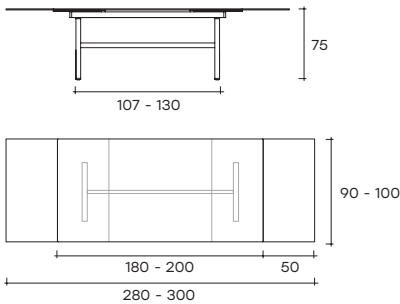

**Dimensione custom (solo profondità):**  
P. min. 90 cm - P. max. 100 cm.

**Custom dimension (only width):**  
P. min. 90 cm - P. max. 100 cm.

dimensioni L, P, H dimensions L, W, H (cm)	COD./CODE	L	P/W	H	peso netto net weight (kg)	peso lordo gross weight (kg)	volume imballo package volume (m <sup>3</sup> )
Tavolo allungabile con piano in vetro trasparente retroverniciato in tinta Cat.1. <i>Extendible table with top in transparent back-lacquered glass - color Cat.1.</i>	<b>HP-AL180 /V-</b>	180 (280)	90	75	141	200	0,76
	<b>HP-AL200 /V-</b>	200 (300)	100	75	156	216	0,82
Tavolo allungabile con piano in vetro trasparente fuso retroverniciato in tinta Cat.2. <i>Extendible table with top in transparent fused back-lacquered glass - color Cat.2.</i>	<b>HP-AL200 /VF-<u>  </u></b>	200 (300)	100	75	156	216	0,82
Tavolo allungabile con piano in vetro extralight acidato retroverniciato in tinta Cat.3. <i>Extendible table with top in extralight acid-etched back-lacquered glass - color Cat.3.</i>	<b>HP-AL180 /VXA-<u>  </u></b>	180 (280)	90	75	141	200	0,76
	<b>HP-AL200 /VXA-<u>  </u></b>	200 (300)	100	75	156	216	0,82

## VETRO RETROVERNICIATO \_ BACK PAINTED GLASS

CAT. COLORE COLOR CAT.	COLORI COLORS	CODICE _ CODE		
		Vetro trasparente Transparent glass	Vetro trasparente fuso Fused transparent glass	Vetro extralight acidato Etched extralight glass
<b>CAT.1</b> Tinta unita Plain color	Grigio grafite Grey graphite	<b>V-GR</b>		
	Rosso vinaccia Wine red	<b>V-VI</b>		
	Testa di moro Dark brown	<b>V-MR</b>		
<b>CAT.2</b> Tinta metallizzata Metallic color	Grigio lava Lava grey		<b>VF-LA</b>	
	Marrone ramato Copper brown		<b>VF-RA</b>	
<b>CAT.3</b> Tinta speciale effetto materico Textured effect	Marrone nuvolato Cloudy brown			<b>VXA-MN</b>
	Piombo satinato Glazed lead			<b>VXA-PS</b>

Hype è disponibile anche nelle altre finiture di Cat.2 per vetro fuso.  
*Hype is also available in the other finishes of fused glass Cat.2.*



---

**FINITURE**  
**FINISHES**

---

**Base in metallo**  
**Metal base**

grigio lava  
lava grey

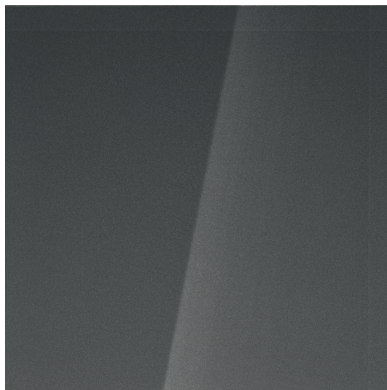
**Piano in vetro retroverniciato**  
**Back-painted glass top**

grigio grafite  
graphite grey

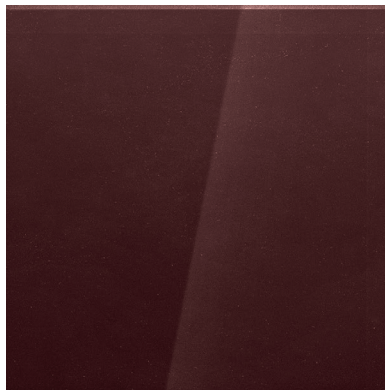

rosso vinaccia  
wine red

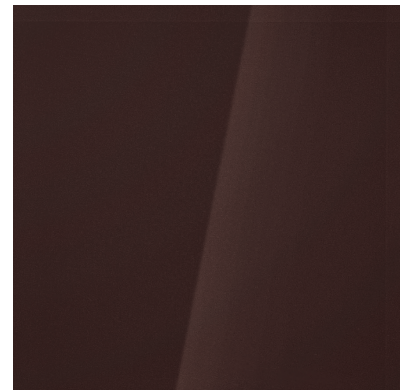

marrone testa di moro  
dark brown



---

**FINITURE  
FINISHES**

---

**Piano in vetro extralight acidato retroverniciato  
Back-painted acid-etched extralight glass top**

piombo satinato  
glazed lead



marrone nuvolato  
cloudy brown

**Piano in vetro fuso retroverniciato  
Back-painted fused glass top**

grigio lava  
lava grey



marrone ramato  
copper brown