

LONGO STORAGE UNITS

— By Ramos&Bassols —

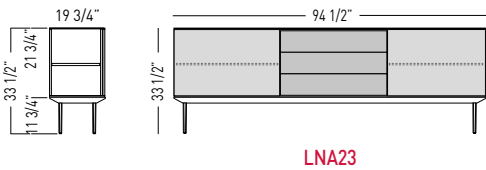

CREDENZA UNITS

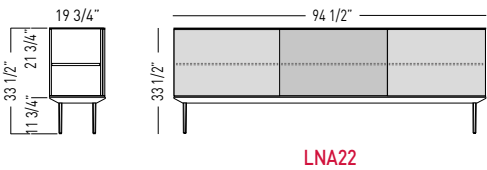
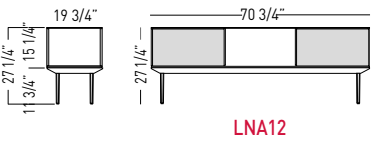

STORAGE UNITS

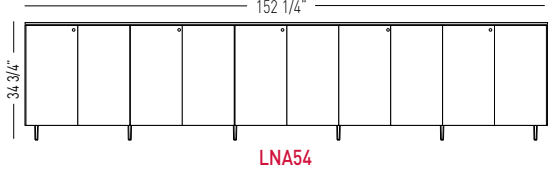
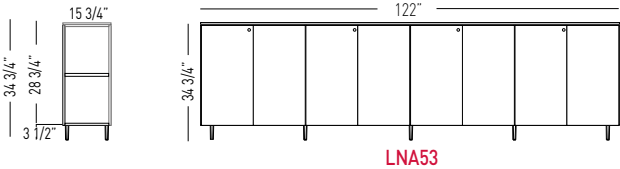
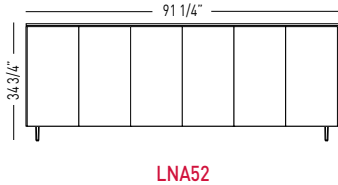
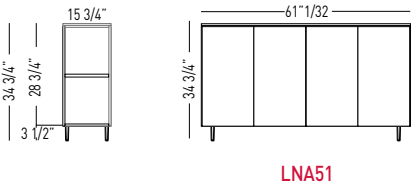



AUXILIARY CREDENZA AND STORAGE UNITS - TECHNICAL FEATURES

- 1 MFC Top Cover 3/4" thickness.
- 2 MFC base, 3/4" thickness.
- 3 MFC Vertical Separators 3/4" thickness, Back panel 3/4" thickness.
- 4 Glass sliding door in White or Black Glass 1/2".
- 5 Thermoplastic runner inserted in the base. Plane base without any obstacle.
- 6 Die Cast profiles in White, Black and Silver Finishes.
- 7 Die Cast union squares in White, Black and Silver.
- 8 Feet:
 - injected with aluminum in a pandramid shape, covered in epoxy paint in white, silver, black finishes and polished finish.
 - Wood in a pandramid shape in Beech finish.
 - Leveler made from injected aluminium with PVC anti-skid pad.

MELAMINE



STRUCTURE



LONGO AUXILIARY CREDENZA AND STORAGE UNITS PROGRAM

2 Sliding door model

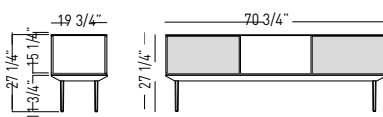

LNA12

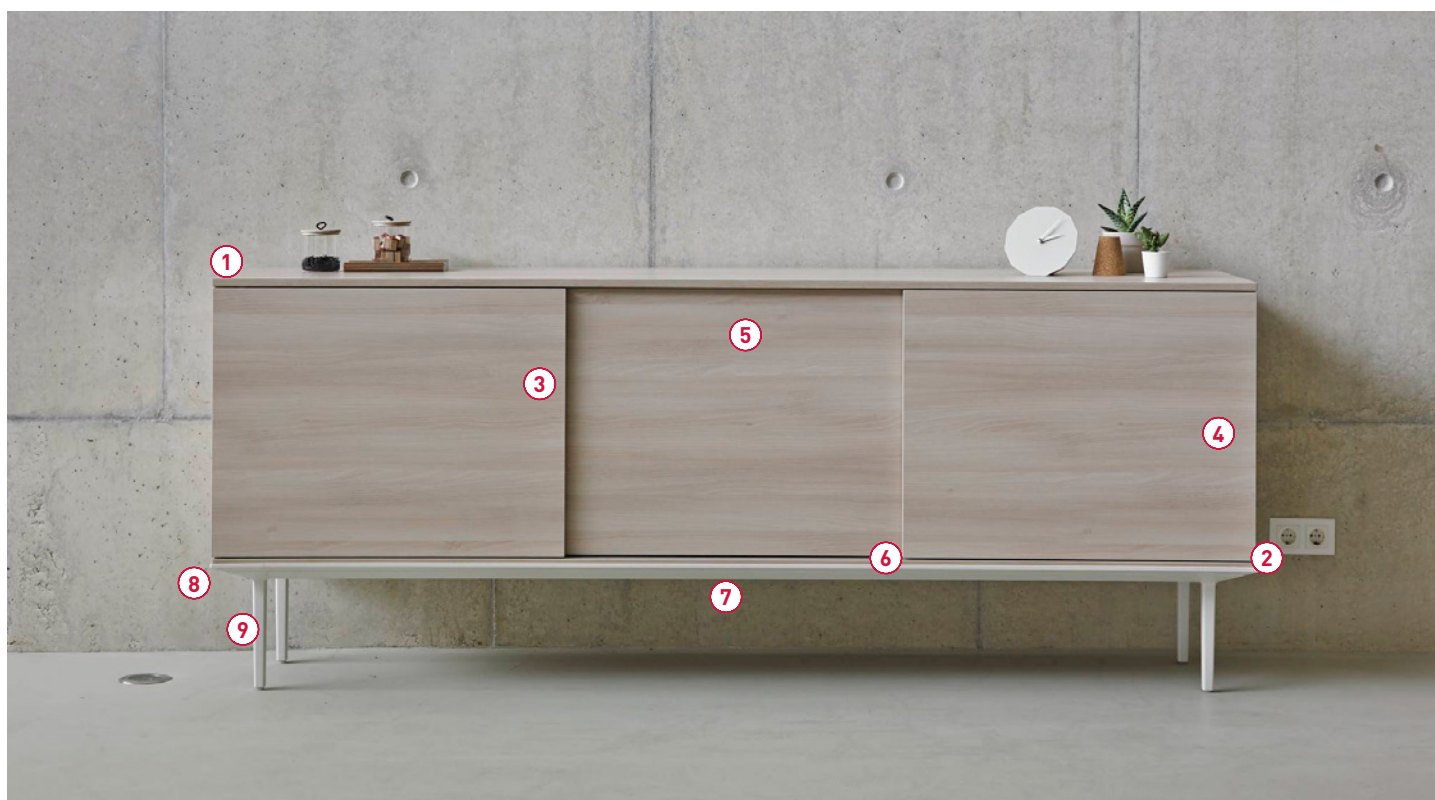

AUXILIARY CREDENZA AND STORAGE UNITS - TECHNICAL FEATURES

- 1 MFC Top Cover 3/4" thickness
- 2 MFC base, 3/4" thickness.
- 3 MFC Vertical Separators 3/4" thickness, Back panel 3/4" thickness
- 4 Shelves 3/4" thickness
- 5 3/4" thickness MFC sliding door.
- 6 Thermoplastic runner inserted in the base. Plane base without any obstacle.
- 7 Die Cast profiles in White, Black, Silver and Polished Finishes
- 8 Die Cast union squares in White, Black, Silver and Polished
- 9 Feet:
 - injected with aluminum in a pandramid shape, covered in epoxy paint in white, silver, black finishes and polished finish.
 - Wood in a pandramid shape in Beech finish.
 - Leveler made from injected aluminium with PVC anti-skid pad.

MELAMINE



STRUCTURE



LONGO AUXILIARY CREDENZA AND STORAGE UNITS PROGRAM

3 Sliding door model

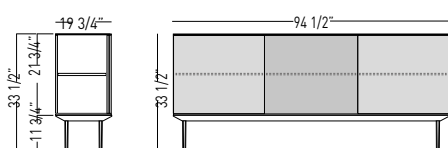

LNA22

2 Sliding door model and 3 drawers

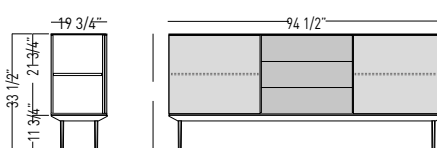

LNA23



AUXILIARY STORAGE UNITS - TECHNICAL FEATURES

- 1 MFC Visible Top Cover 1/2" thickness. MFC invisible Top Cover 3/4" thickness.
- 2 MFC base, 3/4" thickness.
- 3 Lateral panels, MFC 3/4" thickness.
- 4 Visible Back panel 3/4" thickness.
- 5 MFC Vertical Separators 1 1/4" thickness.
- 6 Shelves are manufactured by mfc 3/4" thickness.
- 7 MFC Door jamb 3/4" or in White or Black Glass 5 mm thickness. Hinges with three-dimensional regulation and automatic assembly. Soft closing system hinges.
- 8 Top security lock.
- 9 Die Cast aluminum feet in White, Black, silver and polished finishes with PVC anti-skid pad.

MELAMINE



STRUCTURE



LONGO STORAGE UNITS PROGRAM

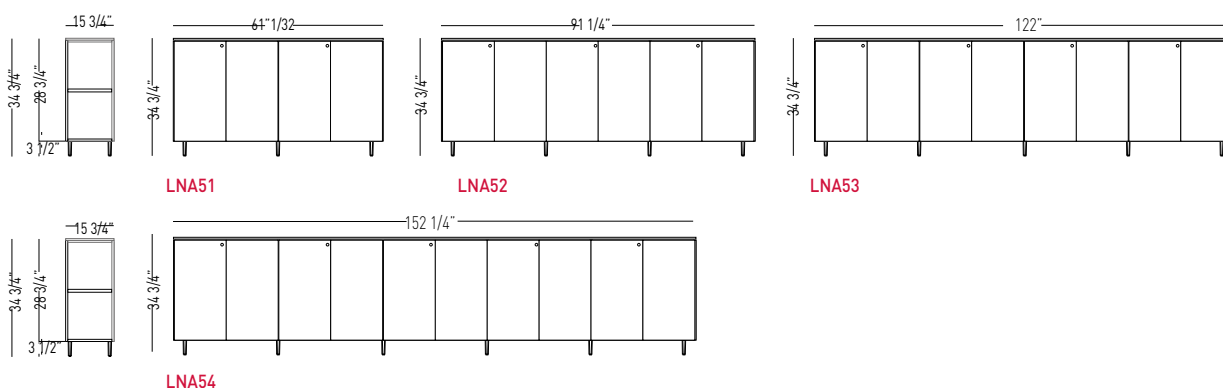



MATERIALS

Maximum use of materials to eliminate and minimize scraps. Use of recyclable and recycled materials in those components that do not affect the functionality and durability.

HIGH%
RECYCLED
MATERIALS



PRODUCTION

Maximum optimization of energy use. Minimal environmental impact. Last generation technological systems. Zero discharge of wastewater. No VOC coatings. Processes free of heavy metals, phosphates, OC and COD.

100%
RECYCLABLE
ALUMINIUM, STEEL
& WOOD



TRANSPORT

Detachable systems. Volumes that facilitate the optimization of space. Maximum reduction of energy consumption by transport.

100%
RECYCLABLE
PACKAGE AND THINNER
FREE



USE

Quality and warranty. Long lasting. Replacements available.

EASY
TO CLEAN
AND MAINTAIN



DISPOSAL

Waste reduction. Supplier-manufacturer packaging reuse system. Components are easy to be separated. Inks in packaging are water-based, without solvents.

HIGH%
RECYCLABLE
MATERIALS

CERTIFICATES AND REFERENCES

The different programmes get points in different environmental categories to get the LEED certificate (sustainability, material and resources, water, energy and atmosphere, inner environment quality, innovation and design).



The mark of
responsible forestry



PEFC Certificate



EN ISO 14006:2011
ECODESIGN Certificate



UNE-EN ISO 9001:2008
ISO 9001 Certificate



UNE-EN ISO 14001:2004
ISO 14001 Certificate



E1 Certificate
by EN 13986



California 93120
Compliant Formaldehyde Phase 2



ACTIU TECHNOLOGY PARK
LEED® PLATINUM certified by USGBC
Leadership in Energy & Environmental Design
LEED® Gold certified 2011 • LEED® Platinum certified 2017