



907.41/42
907.43/44



907.45
907.47
907.49



907.51

			h	b	h	h	h	h	Kg	⊗	CBM
907.41/42	Sgabello con 4 gambe in metallo Barstool with 4 legs in steel	FIX	99/86	48/48	37/37	55/55	78/65	-	12/11.5	x1	0.395
907.43/44	Sgabello con 4 gambe in metallo Barstool with 4 legs in steel	⊗	99/86	48/48	37/37	55/55	78/65	-	12/11.5	x1	0.395
907.45	Sgabello con 4 gambe in legno Barstool with 4 wooden legs	FIX	99	48	37	55	78	-	12.2	x1	0.395
907.47	Sgabello con 4 gambe in legno Barstool with 4 wooden legs	⊗	99	48	37	55	78	-	12.2	x1	0.395
907.49	Sgabello con 4 gambe in legno Barstool with 4 wooden legs	⊗	99	48	37	55	78	-	12.2	x1	0.395
907.51	Sgabello con colonna centrale regolabile Barstool with adjustable central column	⊗ ↑	81-106	48	37	55	60-85	-	19	x1	0.334



shell in soft touch



steel legs



wooden legs



matt chrome steel



L = round, conically tapered wooden legs

- ⊗ 360° swivel mechanism without memory return
- ⊗ 360° swivel with memory return





h 907.45



h 907.51

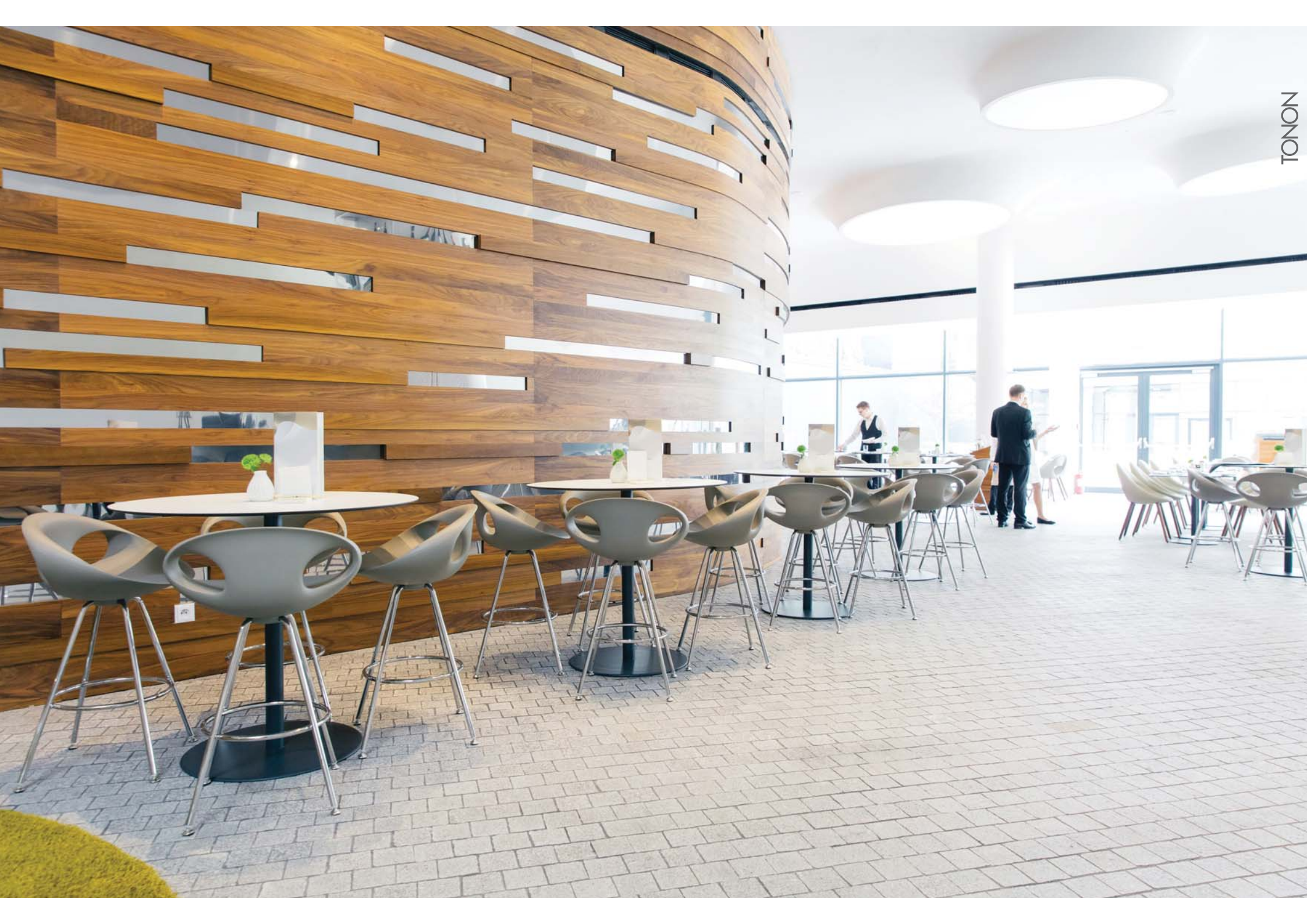



TONON